

Model XS-B30-1

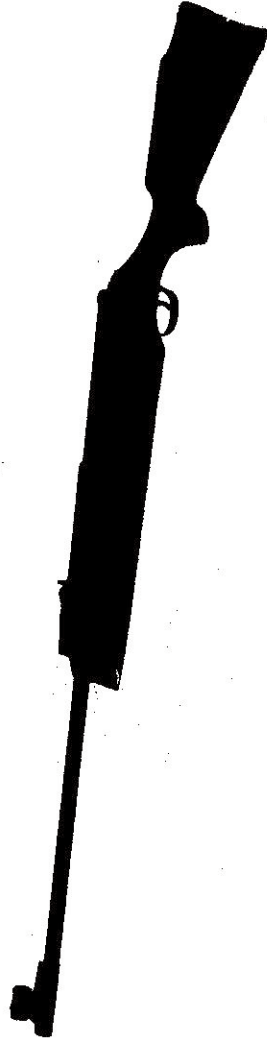

OWNER'S MANUAL

**Congratulations** on your purchase of one of the finest air rifles available today. Proper care and use of your new air rifle will bring you a lifetime of shooting enjoyment.

You must carefully read and understand everything in this manual before you attempt to shoot. You must read and understand all safe handling techniques of this or any other shooting instrument. Failure to do so could cause harm to you or to innocent bystanders and could cause damage to your rifle. Good common sense is the foremost technique which applies to all gun handling.

**This rifle is NOT a toy ! It requires adult supervision and careful handling . . . follow the rules below!**

**Basic safety rules ( in a addition to good common sense):**

- Never, ever, point your rifle at anything except an approved target at an approved shooting facility.
- Make certain your rifle is empty and not charged except when you are actually ready to shoot.
- Always point the muzzle in a known safe direction, even when not in use. Always have full control of your rifle.
- Never load your rifle until you are actually ready to fire.

- Never use your rifle if you are not fully alert. Never use alcohol or drugs or even prescription drugs while shooting or handling your rifle.
- Be certain of your target before shooting. Know where your pellet will go even if you miss your target.
- Do not shoot at rocks or still water; there is always danger of ricochet.
- Never let a child use your rifle. It is not a toy. It is a high velocity target shooting instrument.
- Always wear eye protection which is approved for shooting. You should also wear hearing protection even though you are shooting an air rifle.
- Use only high quality pellets of proper caliber for your rifle. Using the wrong caliber will cause failure and could cause harm to you or your bystanders.
- Never pull the trigger on an empty rifle; escaping air gas is strong enough to cause serious harm. Your rifle is not a toy!
- Do not alter, adjust or modify your rifle; doing so will void your product support and could make your rifle dangerous. If you think you need repair, call us. We're here to help.
- Have fun; that's what your rifle was designed for!

— SPECIFICATIONS —

Caliber: .177 or .22  
Rifling: Right turning, 1 in 12;  
Sight radius: 36.2"  
Muzzle velocity: 4.5 mm,  $\geq 900$  f p s      5.5 mm,  $\geq 680$  f p s  
Total weight: 9.9 lbs  
Total length: 49.1"  
Trigger PULL: 2.2 lbs ~ 6.65 lbs

DESCRIPTION :

Your new air rifle is a high pressure, spring loaded, piston driven, side cocking, air rifle firing lead pellets only.

The side cocking lever is a superior design which allows the sights of the rifle to remain rigidly in place; unlike barrel cocking types. The side cocking lever is adjustable allowing you to apply the amount of spring leverage you desire. The rifle uses an open rear, adjustable sight and a ramped post front sight. The rifle has a solid wood stock in one piece with a solid rubber recoil pad formed for correct shooting posture. It is durable, accurate and attractive rifle. It requires safe handling and a modicum of maintenance.

SAFETY MECHANISM :

Your Super Max Air rifle utilizes two automatic double locking safety mechanisms. The first is the trigger safety and is located at the rear of the receiver. It will automatically engage every time the rifle is fully cocked. Even if it is automatic, common sense demands that you check it each time.

The additional bolt release safety button is located on the left side of the bolt opening and holds open the cocking lever. You must depress and hold down the safety button to return the cocking lever to its original position.

When you are ready to shoot, you must disengage the trigger safety on the rear of the receiver by simply pushing it forward.

#### **COCKING PROCEDURE:**

Hold the rifle by the forend of the stock in your left hand and place the buttstock securely to your upper thigh. Keep a good grip on the rifle at all times. Grasp the front of the long cocking lever on the right side of the rifle. Now fully swing the cocking lever to the right rear in arc motion as far as it will go. It will lock in the open position.

You may change the 'swing' of the arc and therefore the leverage by extending the length of the cocking lever. Do so by pressing the small button on the cocking lever which allows the end of the lever to slide forward.

At this time check to see that the chamber is empty and the barrel is clear.

Load one proper pellet, by hand, carefully and directly into the barrel chamber. The cocking lever is still locked open at this time. Do not attempt to load the chamber unless the lever is fully cocked.

Next, with your left hand, retain your grasp of the forend and with your left thumb, hold down the safety button in the stock on the left side of the chamber area. Now close the cocking lever with your right hand.

You are now ready to shoot. Recall that the safety on the receiver is on automatically. Do not move it to 'off' until you are ready to shoot.

#### SIGHTING :

The sight picture you need for your Super Max is the same as same as that for cartridge rifles . Your rifle is perfect for transitional training.

The rear sight is adjustable for windage and elevation. It has a wide and deep notch which is especially good for quickly gaining the correct sight picture. The front sight should be precisely level with the top of the rear sight and horizontally in the center of the notch. This is the correct picture for accuracy. Maintain the very same sight picture every time you shoot.

Sight adjustment: the rear sight is adjustable for both windage and elevation . To change the point of impact of the pellet depends on where you want to move it.

To change the elevation, simply turn the screw on the top of the rear sight to the right and the point of impact will move down. Turn the screw counter clockwise to raise the elevation of the impact point .

To change the horizontal impact point move the screw on the side of the rear sight either clockwise or counter clockwise as required to achieve the desired impact point. Moving the screw clockwise will move the impact point to the right. Moving the screw counter clockwise will move the impact point to the left. The sight contains very fine adjustments. Move the sights only 1/4 turn at a time to test your results.

There is even further vertical adjustability in the front sight. You can see that it is mounted on a ramp base. Simply unlock the locking screw in the base of the sight and you can easily move it up or down the ramp to enhance vertical adjustability( in addition the vertical adjustment in the rear sight).

## SHOOTING :

After the rifle is pointed at the target and you are satisfied with the sight picture, you may commence the firing procedure by pushing forward on the rear mounted safety and squeezing the trigger . Keep the rifle pointed down range , even after shooting and throughout the loading process.

Your rifle is equipped with a fully adjustable trigger which is the same as tournament grade rifles.

To adjust trigger weight: through the hole in the trigger guard, insert a small screw of proper size into the front screw head. To make the trigger weight heavier , turn the screw to the right . Do not turn

more than 1/4 turn at a time. To make the trigger lighter, turn it in the opposite direction. Do not turn it more than 1/4 turn at a time. Be very careful! The trigger mechanism is a precision device and requires very small adjustments.

To adjust trigger travel: Through the same hole, adjust the rearmost of the two screws. Turn the screw to the right to shorten the travel of the trigger. Turn the screw to the left to lengthen the travel of the trigger. Never make more than 1/4 turn at a time .

#### **TELESCOPIC SIGHTS :**

Your Super Max Air Rifle is equipped with a dove tail scope mounting system which can accept a wide variety of scope and mount systems

Regardless which system you choose , simply be sure to follow the scope mount directions to assure that the scope mounts lock into the rifle mount, securely. It is easy to do but you must do it right. For accuracy, the scope cannot be allowed to move. That is a function of securing the mounts to the rifle and the rings to the scope. Your dealer will be glad to help you .

#### **PRODUCT SUPPORT :**

We are here to help you . If you have any questions or concerns, please call us for help . That's our job, after the sale, support. We want you to be happy with your rifle and to encourage you to see other products and accessories.



SCHEMATIC DRAWING :

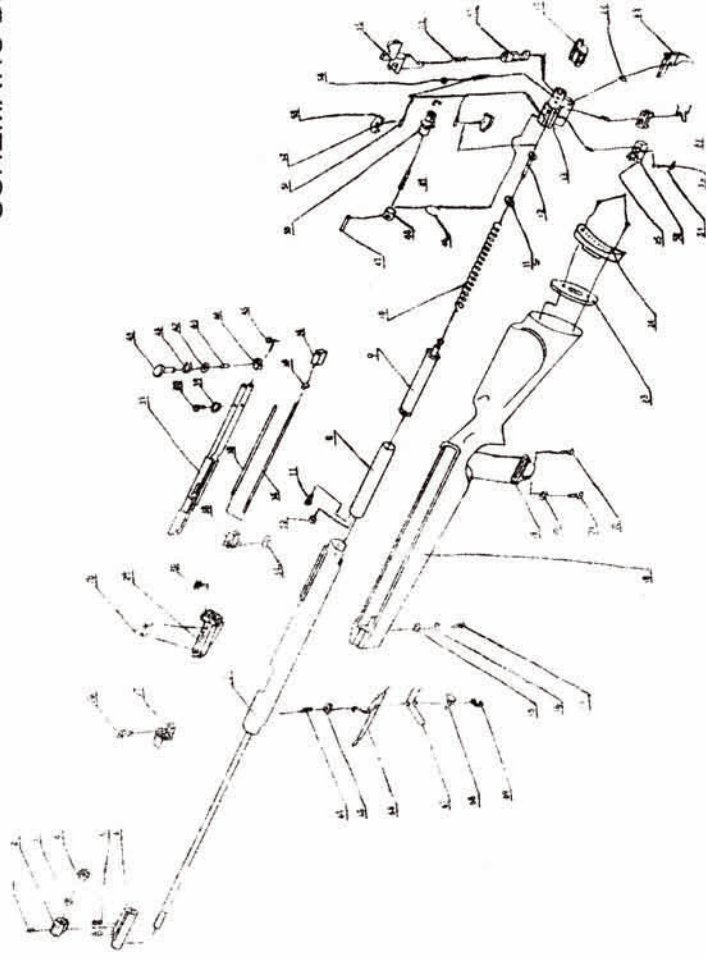

Max velocity parts list:

Number	Name	Amount
1	Screw	1
2	Front sight moving support	1
3	Front sight	1
4	Front sight locking screw	1
5	Screws	2
6	Front sight support	1
7	Rifle body assembly	1
8	Air cylinder	1
9	Piston assembly	1
10	Piston spring	1
11	Washer	1
12	Piston spring plunger	1
13	Shooting support assembly	1
14	Locating sleeve	1
15	Washer	1
16	Spring washer	1
17	Screw	1
18	Stock	1
19	Trigger guard	1

Max velocity parts list:

Number	Name	Amount
20	Washer	1
21	Screw	1
22	Screw	1
23	Recoil pad	1
24	Recoil bearing assembly	1
25	Screws	2
26	Linking nut	1
27	Linking sleeve	1
28	Screws	2
29	Rear sight assembly	1
30	Up - down adjusting screw	1
31	Locating plate	1
32	Cylinder linking nut assembly	1
33	Linking rod sleeve	1
34	Linking rod	1
35	Nut	1
36	Linking nut for cocking lever	1
37	Cocking lever assembly	1
38	Turning pin	1

Max velocity parts list:

Number	Name	Amount
39	Blocking ring	1
40	Pin for cocking lever	1
41	blocking ring	1
42	Washer	1
43	Linking sleeve	1
44	Locating sleeve for cocking lever	1
45	Coping rod cap	1
46	Blocking spring	1
47	Pin	1
48	Pad lump	1
49	Moving lump spring	1
50	moving lump	1
51	Pins	2
52	Blocking lumps	2
53	steel ball spring	1
54	Steel ball	1
55	Safety (small button)	1
56	Coping rod spring	1
57	Safety coping rod	1

Max velocity parts list:

Number	Name	Amount
58	Transmission jump assembly	1
59	Transmission jump spring	1
60	Sear	1
61	Sear spring	1
62	Pins	3
63	Trigger	1
64	Rack plato linking screw	1
65	Serrated nut	1
66	Whole course safety assembly	1
67	Rack plate turning spring	1
68	Pin	1
69	Blocking ring	1
70	Seal	1
71	Cylinder linking screw	1